

Transition for PVC/HDPE

Materials

PVC

Stainless Steel Insert

Stainless Steel Ring

HDPE Pipe

Fully Pressure Rated



Nominal Size (In.)	PVC O.D. A	PVC I.D. B	Est. I.D. Pressed SDR 9 C	Est. I.D. Pressed SDR 11 C	HDPE I.D. SDR 9 D	HDPE I.D. SDR 11 D	HDPE O.D. E	PVC Length F	Exposed HDPE Length G	Total Length H
0.5	1.25	0.848	0.5	0.54	0.64	0.68	0.84	2.34	~6.7	~9
0.75	1.53	1.058	0.65	0.68	0.807	0.851	1.05	2.5	~7	~9.5
1	2	1.31	0.81	0.86	1.003	1.051	1.315	3	~6.25	~9.25
1.25	2.375	1.65	1.08	1.15	1.27	1.34	1.66	4.5	~5.75	~10.25
1.5	2.375	1.91	1.15	1.26	1.453	1.533	1.9	4.5	~5.75	~10.25
2	3.025	2.375	1.54	1.64	1.815	1.917	2.375	5.75	~5.5	~11.25
3	4.3	3.5	2.48	2.63	2.675	2.836	3.5	6.5	~4.5	~11
4	5.56	4.5	3.17	3.36	3.44	3.633	4.5	6.5	~8.5	~15
6	8	6.625	4.5	4.8	5.07	5.35	6.625	12	~18	~30

Stainless Steel ID Insert Standard - PVC ID Insert Available

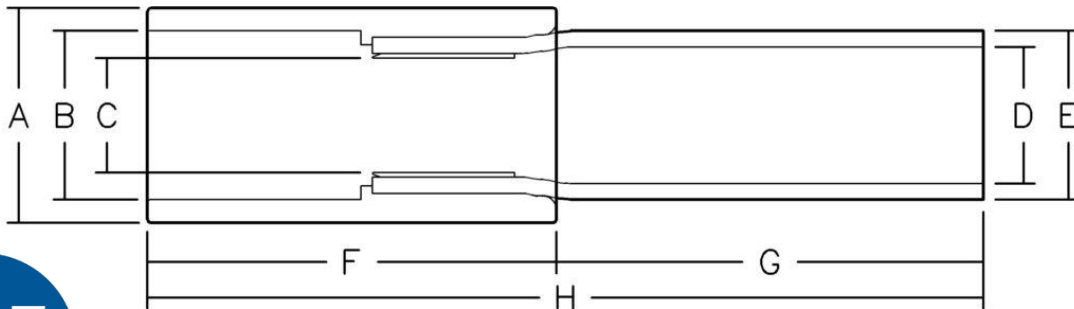

Certified to
NSF/ANSI/CAN 61