



# Series 710

## DIPS HDPE Transition with Male NPT

**Available In:**  
**Carbon Steel Epoxy-Coated**  
**304 Stainless Steel**  
**316 Stainless Steel**  
**Standard SDR Sizes 7, 9, 11, 17**  
**Import or Domestic**  
**Fully Pressure Rated**



| Nominal Size (In.) | Coupling O.D. A | Pressed DIPS SDR11 PE Pipe I.D. B | Exposed DIPS SDR11 PE Pipe I.D. C | Exposed PE Pipe O.D. D | Coupling Length E | Exposed PE Pipe Length F | Overall Length G | Thread Length H |
|--------------------|-----------------|-----------------------------------|-----------------------------------|------------------------|-------------------|--------------------------|------------------|-----------------|
| 4.500              | ~3.200          | 3.876                             | 4.800                             | 4.5                    | 7.5               | 12                       | 1.73             | 4.500           |
| 6.625              | ~4.850          | 5.571                             | 6.900                             | 5.5                    | 7.5               | 13                       | 1.95             | 6.625           |
| 8.625              | ~6.400          | 7.305                             | 9.050                             | 6                      | 9                 | 15                       | 2.15             | 8.625           |
| 10.750             | ~8.000          | 8.961                             | 11.100                            | 7                      | 9                 | 16                       | 2.36             | 10.750          |
| 12.750             | ~9.660          | 10.656                            | 13.200                            | 9.4                    | 8.6               | 18                       | 2.56             | 12.750          |

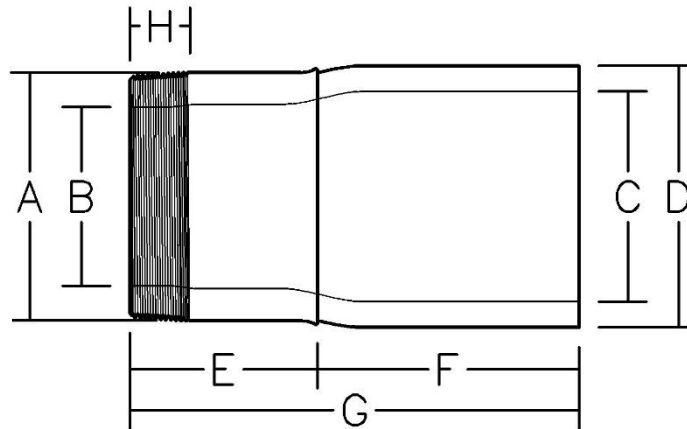

Note: This fitting does not meet ASTM D2513. The fitting CANNOT be used in natural gas applications.



Certified to NSF/ANSI/CAN 61

Made to ANSI/ASME B1.20.1 – 2013  
 Meets ASTM 1598 and ASTM 1599

1101 McKinley Street – Anoka, MN 55303 (763) 786-6682  
 Fax: (763) 786-2167 www.poly-cam.com