



# Series 710

## Transition with Heavy Duty Male NPT

**Available In:**

- Carbon Steel Epoxy-Coated**
- 304 Stainless Steel**
- 316 Stainless Steel**

**Standard SDR Sizes 7, 9, 11, 17**

**Import or Domestic**

**Fully Pressure Rated**



Nominal Size (In.) HD (SS/CS)	Coupling O.D. A	Pressed SDR11 PE Pipe I.D. B	Exposed SDR11 PE Pipe I.D. C	Exposed PE Pipe O.D. D	Coupling Length E	Exposed PE Pipe Length F	Overall Length G	Thread Length H
1	1.44	~0.77	1.06	1.315	2	6	8	0.82
1.25	1.74	~1.09	1.34	1.66	2.6	5.4	8	0.875
1.5	2	~1.28	1.533	1.9	2.6	5.4	8	0.9
2	2.5	~1.62	1.917	2.375	3.209	4.791	8	1.06

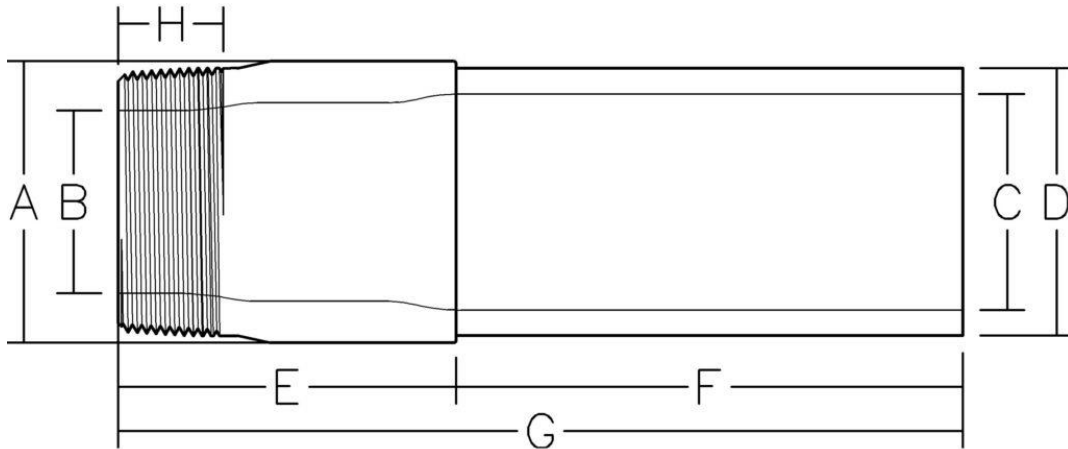

Certified to  
NSF/ANSI/CAN 61

Note: This fitting does not meet  
ASTM D2513. The fitting CANNOT  
be used in natural gas applications.

1101 McKinley Street – Anoka, MN 55303 (763) 786-6682  
Fax: (763) 786-2167 www.poly-cam.com

Revision Date: 9-14-2024