

Transition with Male NPT

Available In:

Carbon Steel Epoxy-Coated
304 Stainless Steel
316 Stainless Steel
Standard SDR Sizes 7, 9, 11, 17
Import or Domestic
Fully Pressure Rated



Nominal Size (In.)	Coupling O.D. A	Pressed SDR11 PE Pipe I.D. B	Exposed SDR11 PE Pipe I.D. C	Exposed PE Pipe O.D. D	Coupling Length E	Exposed PE Pipe Length F	Overall Length G	Thread Length H
0.5	0.990	~0.625	0.68	0.840	1.8	7.2	9	0.78
0.75	1.240	~0.79	0.85	1.050	1.9	7.05	8.95	0.8
1	1.315	~0.84	1.06	1.315	2	6	8	0.98
1.25	1.660	~1.06	1.34	1.660	2.6	5.4	8	1.01
1.5	1.900	~1.28	1.53	1.900	2.65	5.35	8	1.03
2	2.375	~1.64	1.92	2.375	3	5	8	1.06
2.5	2.875	~1.99	2.31	2.875	3.75	4.25	8	1.57
3	3.500	~2.42	2.83	3.500	4	4	8	1.63
4	4.500	~3.23	3.63	4.500	4.5	7.5	12	1.73
5	5.563	~4.0	4.49	5.563	5	8	13	1.84
6	6.625	~4.8	5.35	6.625	5.5	7.5	13	1.95
8	8.625	~6.3	6.96	8.625	6	9	15	2.15
10	10.750	~7.9	8.68	10.750	7	9	16	2.36
12	12.750	~9.5	10.29	12.750	9.4	8.6	18	2.56

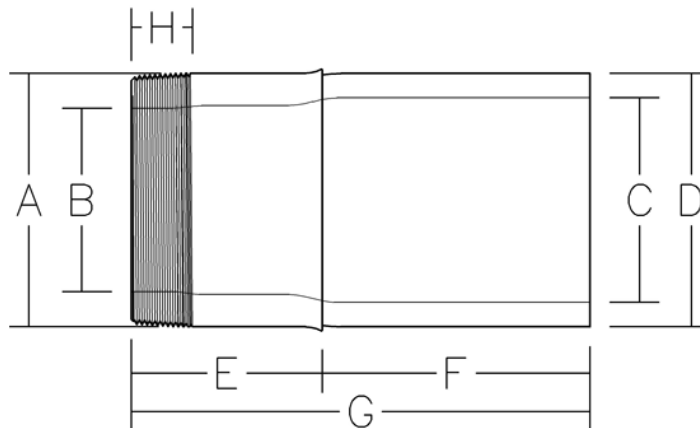

Note: This fitting does not meet ASTM D2513. The fitting CANNOT be used in natural gas applications.



Certified to
NSF/ANSI/CAN 61

Made to ANSI/ASME B1.20.1 – 2013
 Meets ASTM 1598 and ASTM 1599