

Series 911

The Male Flare Nut Transition



Nominal Size Inches	Wrench Flat Size "A"	Pressed SDR9 PE Pipe I.D. "B"	Pressed SDR11 PE Pipe I.D. "B"	Exposed SDR9 PE Pipe I.D. "C"	Exposed SDR11 PE Pipe I.D. "C"	Exposed PE Pipe O.D. "D"	Coupling Length "E"	Exposed PE Pipe Length "F"	Total Length "G"	Thread Length "H"
0.75	1.375	~0.70	~0.74	0.797	0.839	1.05	1.6	6.64	8.24	0.81
1	1.75	~0.93	~0.98	1.003	1.051	1.315	1.97	6.5	8.47	1.125
1.25	2.25	~0.95	~1.04	1.27	1.34	1.66	2.5	6	8.5	1.3
1.5	2.75	~1.25	~1.33	1.453	1.533	1.9	3.02	5.4	8.42	1.4
2	3.5	~1.49	~1.59	1.815	1.917	2.375	3	5.5	8.5	1.4

Copper Tube Size HDPE also available
 All materials meet the requirements of NSF Standard #61, AWWA 800-89

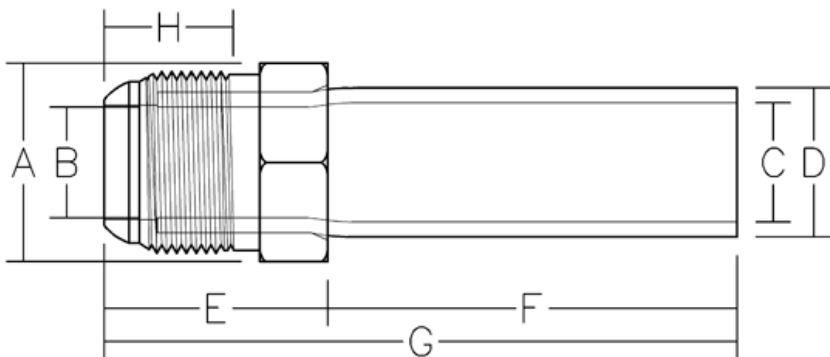

Fully pressure rated • Standard SDR sizes 7,9,11
 Manufactured to D1599, D1598, F-714

11/00 © Registered Trademark Poly-Cam, Inc. - US Patent # 5,211,429